

EverythingAttachments Post Hole Diggers

Model: ETA Compact
ETA 6900
ETA 6900HD
ETA 7500

OWNER AND OPERATOR'S MANUAL



CAUTION



SAFETY FIRST READ ALL PAGES BEFORE USING

Seller or Owner Should Pass On
This Manual to User

T.C. Corriher Implement Co. Inc.
DBA: Everythingattachments.com
12 South Ashe Avenue
Newton, NC 28658

ADDITIONAL COPIES AVAILABLE

Warning!



**Safety
First**

MACHINERY CAN HURT YOU

WARNINGS

DO NOT PERMIT RIDERS ON MACHINERY

**MACHINERY, IN A LIFT POSITION, CAN FALL WHILE OPERATING OR WHEN
SITTING STILL**

STAY AWAY FROM OPERATING MACHINERY - KEEP OTHERS AWAY

- * Observe and follow instructions obtained on decals attached to farm machinery. The wide variety of warning, caution, and instructional decals are placed on machinery for YOUR safety. Always keep hands, feet, and clothing away from all moving pads.
- * Make certain that everyone is clear of the machine before starting power unit or activating any drive mechanism.
- * Keep hands, feet, and clothing away from moving parts of the machine. Do not wear loose clothing.
- * Keep children off, and away, from all machinery.
- * Be sure that all shields or guards are in place before any machine is started.
- * Replace any damaged or misplaced guards or shields.
- * Keep all machinery free of excessive accumulation of crop material or other debris.
- * Stay alert from obstructions, ditches and other hazards when operating machinery.
- * Operate machinery at a speed to match the field and crop condition and/or operator proficiency.
- * Shut off the tractor engine or power unit before attempting to refuel. **DO NOT SMOKE!** Refuel in a well ventilated area and avoid spilling fuel.
- * Always shut off the engine before leaving the operator's platform to adjust, lubricate, clean or unclog a machine, unless otherwise specified in the operator's manual.
- * Wait until all power driven pads have stopped before attempting to perform any inspection or servicing of the machine.

- * Provide a temporary guard for knives when working with them.
- * After servicing equipment, be sure all tools, parts, or servicing equipment are moved before starting the machine.
- * Before restarting operation, replace or secure all safety shields that you have removed or opened for access when making field repairs.
- * Have a fire extinguisher available and in good operating condition. Also take first aid kit.

Safety Warning Labels. Replace If Missing

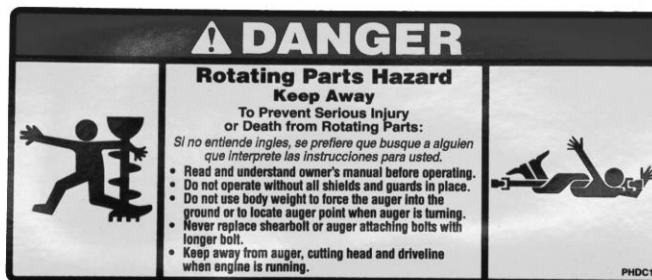

COURTESY OF: T.C Corriher Implement Co. Inc. DBA: Everythingattachments.com
12 South Ashe Avenue Newton, NC 28658

Safety Warning Labels. Replace If Missing

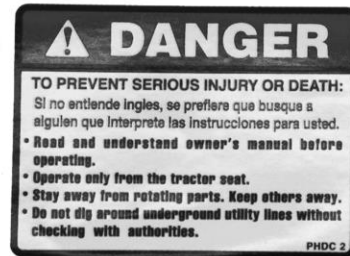
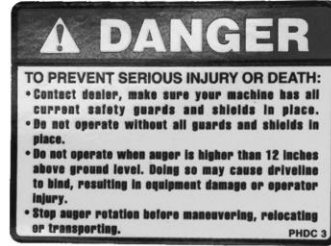

ETA Compact – ETA 6900 – ETA 6900 HD Post Hole Digger OPERATOWS MANUAL AND SAFETY WARNING MESSAGE

!! DANGER! SAFETY FIRST, READ ALL PAGES.

1. GENERAL INFORMATION

Your Everything Attachments posthole digger has been manufactured of quality materials and components. Care has been taken to make this implement as safe as possible to operate; HOWEVER, any machine with moving parts can present a hazard if the operator does not follow common sense rules of safety while operating the machine.

The purpose of this manual is to help you understand the instructions of how to use the equipment safely and be familiar with the safety warning message in order to minimize risks that may occur if the machine is not used properly and if the minimum precautions or attentions are not paid.

The manual will assist you in setting up, operating, and maintaining your digger. Read it carefully and thoroughly; it furnishes information and instruction that will help you achieve many years of dependable performance. These instructions have been compiled from extensive field experience. Some Information may be general in nature due to unknown and varying conditions. However, through experience and these instructions, you should be able to develop procedures suitable to your particular situation.

The illustrations and data used in this manual were current at the time of printing, but due to possible in-line production changes; your machine may vary slightly in detail. Our current production model includes as standard equipment, guards or shields for auger adapters, driveline, input shafts, and safety signs. If you have a machine that does not have current standard safety equipment please contact Everything Attachments about bringing your machine up to the current level of safety. We reserve the right to redesign and change the machines as may be necessary without notification.

2. ASSEMBLY INFORMATION

To attach the A-frame (#1) with the lift pins (#2) to the boom pole (#4) put the bolt provided, into the middle adjustment hole on the boom pole. For adjustment to your tractor, you may have to move the A-frame to another hole so the auger will lift clear of the ground. Tighten the bolt but not excessively. This allows the A-frame to pivot when the digger is raised and lowered by the tractor.

Slide the socket of the lower **LEFT** lift arm of the tractor over the lift (#2) on the A-frame, then slide the right lift arm onto the lift pin, using the adjustment crank lever to position the lift arm at the correct height. Now attach the boom to the tractor where the top-link mounts behind the tractor seat. The top link is not required for operation. Stabilizers should be used to prevent side motion (available from your tractor manufacturer). Remove both sides of auger safety shield (#13) and take auger shear bolts from auger. Use the tractor to raise the boom pole until you are able to slide the auger onto to the gearbox output shaft (#18 on gearbox listing). Now lower the lift on the tractor to slide the output shaft inside the auger. **KEEP HANDS CLEAR OF AUGER IN CASE OF LIFT FAILURE TO REVENT PINCHING OF OPERATOR'S HANDS BETWEEN THE AUGER AND THE DIGGER.** Align the hole for the

shear bolt and replace the shear bolts. Tighten lock washers and hex nuts. (CAUTION: USE OF SHEAR BOLT HARDER THAN GRADE TWO 2 FOR ETA COMPACT AND ETA 6900 OR GRADE 3 FOR ETA 6900 HD COULD CAUSE DAMAGE TO YOUR GEARBOX). NOTE: A longer or protruding shear bolt is more likely to grab loose clothing or gloves, which can result in serious injury or death. Replace two halves of auger safety shield and secure with wing nuts. Depress the locking spring on the (PTO) shaft (#11) and slide coupler onto tractor output shaft until the PTO locking pin clicks in place. Make sure set screw (#10) is tight on PTO shaft at gearbox. The setscrew holds the PTO shaft on the gearbox shaft if the PTO shear pin breaks. Fill gearbox with 90W-gear oil. Unscrew ½” fill plug on top of gearbox and 1/4" overflow plug on side. Fill until oil runs out of side plug (about 1 Qt.). Install both plugs. Grease the PTO universal joints, the metal PTO shaft and spray lube the plastic cover tube so that both will slide in and out freely. Fasten chain on plastic PTO cover at gearbox to the hole in side of PTO shield. Fasten PTO chain at the tractor end of the cover to the lift arms of the actor. This allows the shaft to turn but the outside plastic shield remains stationary to protect the operator from becoming entangled in the PTO shaft and thus causing personal injury.

3. PRE-USE CHECK LIST

Inspect the digger thoroughly after assembly to be certain it is set up properly before operation and use the following checklist as a reminder of points to inspect. Check off each item as it is found satisfactory or after proper adjustment is made.

- Check that all safety shielding is in place.
- Check all bolts to be sure they are tight.
- Check gearbox oil level. It is full when oil runs out of the overflow hole on side of gear box (1/4 inch pipe plug). Use 90 weight gear oil.
- Check that all lubrication points and that all grease fittings have been lubricated (2 fittings).
- Check that cutting edges have been properly installed on auger.

4. PREPARATION

- Always wear relatively tight and belted clothing to avoid entanglement in moving parts. Wear sturdy, rough-soled work shoes. Never operate tractor or implements in bare feet sandals, or sneakers.
- Clear area of branches or other debris that might be thrown by the auger, causing personal injury or damage to the machine.
- **NEVER ALLOW ANYONE AT REAR OF TRACTOR OR NEAR AUGER WHILE OPERATING. The posthole digger was designed for one-man operation from the tractor seat. It is the responsibility of the operator to see that no one is within twenty five feet (25') of the digger when it is in operation.**
- Operate only in daylight or good artificial light.
- Ensure digger is properly mounted, adjusted and in good operating condition.
- Ensure all safety shielding is properly installed.
- Remember, stabilizers should be used to prevent side swing.

5. OPERATION

This digger is designed for use only on tractors with a 540-RPM power take off. The auger is designed to operate just above idle speed. Clear the work area of objects that might be picked up and thrown or entangled in the auger such as vines, tree limbs, wire, etc.

The auger is of the pendulum swinging type and should hang in a vertical position when raised clear of the ground. On the ETA 6900 and ETA Compact there is an **Optional** directing rod (#15) attached to the gearbox to control the swing of the gearbox. It can be moved in or out by loosening the setscrew on the side of the gearbox. This allows the tractor operator, from his seat to straighten the angle of the auger to dig a straight hole. Due to the design of the ETA 6900-HD gearboxes, the directing rod is not required. To prevent possible instantaneous driveline failure, never move digger from hole to hole or transport it while auger is rotating. This could lead to injury from flying pieces of the failed driveline. With auger raised clear of ground drive into position and engage PTO with tractor idling; lower digger slowly and permit it to dig one foot (1ft.) deep. Raise digger and allow auger to clear itself by operating PTO, lower digger and dig another foot deep. Repeat this until hole is to desired depth. To prevent entanglement and possible serious injury or death all persons except for the operator seated on the tractor, should maintain a minimum safe distance of twenty five (25') feet from the auger at all times. In loose and sandy soil, you get a cleaner hole by stopping rotation of the auger before lifting it from the hole and starting it just before it clears the hole to throw the soil on the auger out and away from the hole. **DO NOT SHOVEL** dirt away from a rotating auger as the shovel can be caught and thrown by the auger causing serious personal injury. In wet clay, be very careful not to let the auger go too deep as it may get stuck. If the auger is stuck either in wet clay, roots, or stones, **DISENGAGE** PTO, shut off tractor engine and use large wrench on auger and reverse rotation of the digger. One complete turn of the auger will usually free the auger. Then gently lift the auger with the tractor lift. If it is not free, continue reversing procedure until it can be lifted clear. Do not operate digger on steep hillsides. When digging on uneven or hilly terrain, position the tractor with the posthole digger uphill. If the posthole digger is pointed downhill, the tractor could tip over when attempting to pull the auger from its hole.

!!!!WORK SAFELY-FOLLOW THESE RULES!!!!

6. DAILY CHECK LIST

- Check that digger is properly and securely attached to tractor.
- During inspection, check that all nuts and bolts are secure.
- Check conditions of auger Cutting edges and security of attachment.
- Check that all safety shields are in place.

7. MAINTENANCE

- *keep tractor and digger in good operating condition and all safety devices in place.
- *Periodically tighten all bolts, nuts and screws to ensure digger is in a safe condition to operate.
- *The shear bolt is where the PTO (power take off) shaft yoke fits to the gearbox

COURTESY OF: T.C Corriher Implement Co. Inc. DBA: Everythingattachments.com
12 South Ashe Avenue Newton, NC 28658

- input shaft. Check it for wear before each use.
- *Never replace the shear bolt or auger retaining bolt with any length other than what Everything Attachments specified in the manual.(A longer or protruding fastener is more likely to grab loose clothing or gloves, which can result in serious injury or death).
 - *Check that retaining screw in the PTO yoke is in place and tight. It keeps the PTO yoke from coming off the gearbox input shaft if the shear bolt breaks.
 - *Use ONLY GRADE 2 SHEAR BOLTS ON ETA COMPACT AND ETA 6900. USE ONLY GRADE 3 SHEAR BOLTS ON ETA 6900-HD.
 - *Always use, and maintain in place, all power take off guards furnished with the tractor as well as the power take off-guards and shield furnished with the digger. If a safety shield or guard is removed for any reason, it must be replaced before the machine is operated again.
 - *Spray lubrication on both halves of PTO so the cover freely slides in and out.
 - *Check point and width of auger bit. If bit is worn to the place that it is smaller in width than the round flighting on the auger then replace the bit. If point is bent or dull then replace bit.

8. STORAGE

- * When removing digger from tractor, (A) stand digger upright and brace it to prevent it from falling, (B) chain digger upright by hanging from loop on top of boom, (C) back digger up to a post and chain it upright.
- *In storage position lower the boom end to ground level so no one can bump their head or trip over unit.
- * Do not leave auger drilled in ground as moisture may rust auger and bit.
- * Clean all accumulated debris from digger to prevent rust.
- * To prevent moisture damage during storage, lubricate all lubrication points on digger.
- * Coat auger with oil as needed.
- * Do not lay digger on ground as personnel injury may occur in pushing the digger into an upright position.

9. Training

- *Know your controls and how to stop the tractor engine and digger quickly in an emergency.
- *To avoid injury, do not allow anyone to operate this equipment without proper instructions. Any Person who operates this equipment must be instructed in and be capable of safely operating this unit, attachments and controls.
- *Always use two (2) people to handle heavy, awkward components during assembly, installation, removal or moving the digger.
- *Do not move the tractor while the auger is turning.
- *Do not move tractor while auger is still in the ground. The final responsibility for safety rests with the operator of the machine. He or she is ultimately responsible for safety of himself or herself as well as others in the operating area of the digger.

10. SAFETY WARNING MESSAGE

Carefully read thoroughly and understand your operator's manual as well as the safety-warning message. Failure to understand and obey a safety warning, or recognize a safety hazard, could result in an injury or death to you or others around you.

- This posthole digger was designed for one man operation from the tractor seat. It is the responsibility of the operator to see that no one is within twenty-five feet (25') of the digger when it is in operation.
- Do not operate the digger with another person near, or in contact with any part of the digger, PTO driveline, or auger. Serious personal injury or death may result if any attempt is made to assist digger operation by hand.
- A Person who has not read or understood the owner's manual and safety signs is not qualified to operate the machine. If you do not have an owner's manual or current production safety signs, contact the Everything Attachments.
- Be careful and make sure that everyone who operates this machine knows and understands that it is a very powerful piece of machinery, and if used improperly, serious injury or death may result.
- All things with moving parts are potentially hazardous. There is no substitute for a cautious, safe minded operator who recognizes potential hazards and follows reasonable safety practices. The manufacturer has designed the machine to be used with all its safety equipment properly attached, to minimize the chances of accidents.
- Personal protection equipment including hardhat, safety glasses, safety shoes, and gloves are recommended during assembly, installation, operation, adjustment, maintaining, repairing, and removal or moving the digger.

12. OPERATIONAL SAFETY

- *Disengage power take off (PTO) and shift tractor into neutral before attempting to start the engine. NEVER ALLOW ANYONE NEAR AUGER WHILE OPERATING. STAY 25 FEET AWAY.
- * Never make an adjustment while engine is running; operator must dismount from tractor.
- * Keep children and pets a safe distance away, at least 25 FEET.
- * Always comply with all state and local lighting and marking requirements when operating on highways.
- * Watch for traffic when crossing roads.
- * Consult local utility companies to make certain there are no buried gas lines, electrical cables, etc. in the work area before beginning operation.
- * Stop digger and tractor immediately upon striking an obstruction. Turn engine off, inspect digger and repair any damage before resuming operations.
- * Disengage power to digger and stop engine before dismounting from tractor, making adjustments or unclogging digger.
- * NEVER PLACE HANDS OR FEET NEAR DIGGER WHEN TRACTOR ENGINE IS RUNNING. STAY CLEAR OF ALL MOWING PARTS
- * Do not walk or work under a raised digger or attachment unless it is securely blocked or held in position. Do not depend on the tractor hydraulic system to hold the digger or attachment in place.

COURTESY OF: T.C Corriher Implement Co. Inc. DBA: Everythingattachments.com
12 South Ashe Avenue Newton, NC 28658

- * Do not allow anyone who is not familiar with the safety rules and operational instructions to use the machine.
- * Never allow children to operate or be around this digger.
- * Never place a part of your body where it would be in danger if movement should occur during assembly, installation, operation, mounting removing or moving a digger.
- * Keep in mind that all things with moving parts are potentially hazardous.
- * Never allow the digger to operate while the operator is off the tractor.
- * The digger should be operated with the tractor motor just above idle speed. Faster speeds could be damaging and dangerous.
- * Take all possible precautions when leaving the tractor unattended; Stop engine and remove the key from ignition, disengage PTO, lower digger, shift into gear, set parking brake.
- * Use stabilizer bars, adjustable sway chains, or sway blocks on your tractor lift arms to keep the posthole digger from swinging side to side. Adjust as tightly as possible for best performance.

WARNING!
DO NO LET TRACTOR
MOVE OR ROLL
WITH AUGER IN GROUND
THE AUGER WILL BEND
AND VOID THE WARRANTY.

Parts List

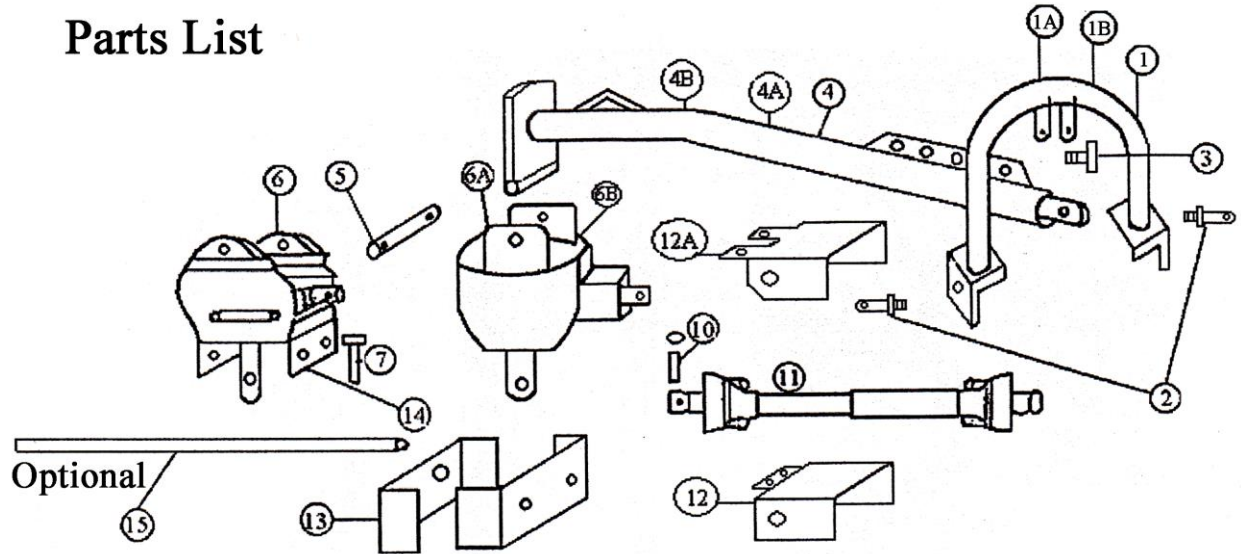

Reference #	Quantity	Description	Fits Models
1	1	A-frame	ETA Compact
1A		A-frame	ETA 6900
1B		A-frame	ETA 6900-HD
2	1	Category I pull pin w/lock washer and nut	All
3	1	3/4" x 2 1/2" bolt, lock washer and nut (A-frame to boom)	All
4	1	Boom Pole	ETA Compact
4A	1	Boom Pole	ETA 6900
4B	1	Boom Pole	ETA 6900-HD
5	1	Hanger shaft w/2 cotter pins	All
6	1	Gearbox	ETA Compact ETA 6900
6B	1	Gearbox	ETA 6900-HD
7	1	3/8 x 3 1/4 grade 2 bolt w/nut	ETA Compact ETA 6900
7B	1	3/8 x 3 1/4 grade 2 bolt w/nut	ETA 6900-HD
10	1	1/4" x 3/4" cone point set screw w/jam nut	All
11	1	Complete class 4 PTO shaft	All
12	1	PTO safety shield	ETA Compact ETA 6900
12A	1	PTO safety shield	ETA 6900-HD
13	2	Auger safety shield	All
14	2	Brackets for auger shields	All
15	1	Optional Guide rod w/set screw Continued on next page	ETA Compact ETA 6900

BOLTS-Buy Local

- 1 $\frac{3}{4}$ " x $2\frac{1}{2}$ " bolt w/lock washer/nut, A-frame to boom.
- 4 $\frac{5}{16}$ " Wing nut w/lock washer, Auger safety shield to brackets.
- 1 $\frac{3}{8}$ " x $3\frac{1}{2}$ " Bolt w/lock washer/nut, PTO shaft to gear box. Grade 2 on ETA Compact and ETA 6900, Grade 3 on 6900 HD.
- 1 $\frac{1}{2}$ " x 3" Grade 2 bolt w/lock washer/nut, Auger to gear box.
- 2 $\frac{7}{16}$ " x $1\frac{1}{2}$ " Carriage bolt w/lock washer/nut, Cutting head to auger.
- 4 $\frac{5}{16}$ " x $\frac{3}{4}$ " Bolt w/lock washer/nut, Shield bracket to gear box.
- 4 $\frac{3}{8}$ " x $\frac{3}{4}$ " Continuous thread bolt w/lock washer/nut, Shield bracket to gear box. ETA Compact and ETA 6900.

WARRANTY AND DISCLAIMER

Everything Attachments (hereafter the “Company”) and sellers of its products warrant products and parts of products it manufactures to be free from defects in material and workmanship for a period of (90) days from date of purchase when such products and parts of products are maintained and used in a customary and ordinary manner.

No warranty is made by the Company either expressed or implied on products manufactured by others.

**THIS WARRANTY IS THE SOLE
WARRANTY
AND IS IN LIEU OF ALL OTHER WARRANTIES,
EXPRESSED OR IMPLIED, INCLUDING ANY
IMPLIED WARRANTY OF MERCHANTABILITY
OR WARRANTY OF FITNESS
FOR A PARTICULAR PURPOSE.**

The exclusive remedy for breach of this Warranty is repair or replacement of parts upon delivery, postage and freight prepaid to the Company at 12 South Ashe Avenue Newton, NC 28658 U.S.A. or refund of purchase price if repair or replacement cannot be practically provided.

In no event shall the Company or the Sellers be liable for consequential or incidental damages, direct or indirect(including but not limited to loss of crops or livestock), due to defects in workmanship or defects in products manufactured by it.

This is the only warranty of the Company. No Seller or any other person has authority to alter or waive any provision of this Warranty as it applies to the Company or to make or add warranties on behalf of the Company. The Company expressly disclaims all liability due to the use or resale of its products or parts of products manufactured by it whether based on contract, negligence, strict liability in tort or otherwise except as expressly provided for in this Warranty as set forth above.